

PERFIL LONGITUDINAL EJE CARRILES CAMBIO DE VELOCIDAD

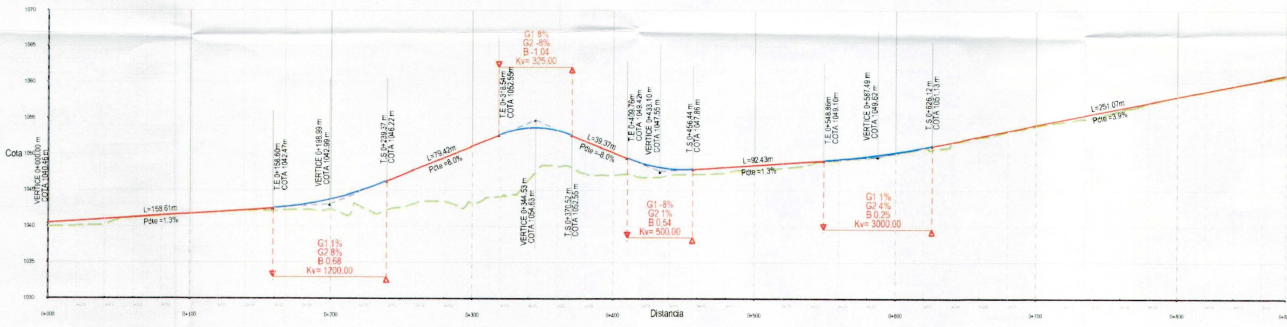

| PK | EXISTENTE | PASANTE | DESMONTE | TERRAPLEN | CURVATURA |
|-------|-----------|---------|----------|-----------|------------------------|
| 0+00 | 1339.80 | | | 0.7 | R=1500.00 Lc=150.00 |
| 0+20 | 1340.00 | 1340.00 | | 0.8 | |
| 0+40 | 1340.14 | 1340.14 | | 0.8 | |
| 0+60 | 1340.17 | 1340.17 | | 0.8 | |
| 0+80 | 1340.14 | 1340.14 | | 0.8 | |
| 0+100 | 1340.14 | 1340.14 | 0.0 | 0.8 | |
| 0+120 | 1340.07 | 1340.07 | | 0.8 | |
| 0+140 | 1340.05 | 1340.05 | | 0.8 | |
| 0+160 | 1340.05 | 1340.05 | | 0.4 | |
| 0+180 | 1340.05 | 1340.05 | | 0.6 | |
| 0+200 | 1340.24 | 1340.24 | | 1.4 | |
| 0+220 | 1340.24 | 1340.24 | | 2.0 | |
| 0+240 | 1340.27 | 1340.27 | | 4.0 | |
| 0+260 | 1340.31 | 1340.31 | | 4.7 | |
| 0+280 | 1340.33 | 1340.33 | | 6.0 | |
| 0+300 | 1340.37 | 1340.37 | | 7.0 | |
| 0+320 | 1340.37 | 1340.37 | | 8.5 | |
| 0+340 | 1340.34 | 1340.34 | | 7.1 | |
| 0+360 | 1340.27 | 1340.27 | | 5.0 | |
| 0+380 | 1340.24 | 1340.24 | | 4.5 | |
| 0+400 | 1340.20 | 1340.20 | | 3.7 | |
| 0+420 | 1340.18 | 1340.18 | | 1.9 | |
| 0+440 | 1340.13 | 1340.13 | | 0.8 | |
| 0+460 | 1340.24 | 1340.24 | | 0.6 | |
| 0+480 | 1340.16 | 1340.16 | | 0.7 | |
| 0+500 | 1340.45 | 1340.45 | | 0.8 | |
| 0+520 | 1340.72 | 1340.72 | | 0.7 | |
| 0+540 | 1340.98 | 1340.98 | | 0.3 | |
| 0+560 | 1340.77 | 1340.77 | | 0.1 | |
| 0+580 | 1340.69 | 1340.69 | | 0.2 | |
| 0+600 | 1340.22 | 1340.22 | | 0.2 | |
| 0+620 | 1336.00 | 1336.00 | | 0.0 | |
| 0+640 | 1335.68 | 1335.68 | | 0.2 | |
| 0+660 | 1335.46 | 1335.46 | | 0.1 | |
| 0+680 | 1335.29 | 1335.29 | | 0.2 | |
| 0+700 | 1335.24 | 1335.24 | | 0.4 | |
| 0+720 | 1335.43 | 1335.43 | | 0.7 | |
| 0+740 | 1335.81 | 1335.81 | | 0.3 | |
| 0+760 | 1336.09 | 1336.09 | | 0.6 | |
| 0+780 | 1337.16 | 1337.16 | | 0.2 | |
| 0+800 | 1337.54 | 1337.54 | | 0.6 | |
| 0+820 | 1338.71 | 1338.71 | | 0.8 | |
| 0+840 | 1339.67 | 1339.67 | | 0.8 | |
| 0+860 | 1340.51 | 1340.51 | | 0.8 | |
| 0+880 | 1340.30 | 1340.30 | | 0.8 | |
| 0+900 | 1340.24 | 1340.24 | | 0.8 | |
| 0+920 | 1340.21 | 1340.21 | | 0.2 | |

NO

MODIFICACIÓN PUNTUAL nº 1
 PLAN PARCIAL SUD-14
 ACCESO 1-CN-234
 PK 346+500
 "Área VALCORBA" -SORIA-

PROMOTOR:
 JUNTA DE COMPENSACIÓN
 UA-1 SUD-14

PLANO:
 PERFIL LONGITUDINAL

PO-2

ESCALA:
 1/1500

EQUIPO REDACTOR:
 ALEJANDRO CABREDO DE MARCO
 Arquitecto

SEGUIMIENTO: Para conocer el nº de planos, véase el
 expediente de MODIFICACIÓN PUNTUAL Nº 001
 PLAN PARCIAL REGIM. ÚNICO DE VALCORBA" o
 PLAN PARCIAL MODIFICACIÓN ÚNICO Nº 001
 GOBIERNO LOCAL: "Área de VALCORBA" (0.307)
 Anexo 4 al expediente de modificación

SORIA, 27 de Mayo de 2017
 Alejandro Cabredo de Marco